

# Prologis Park Beacon Industrial

3200 NW 112 Avenue

Doral, FL 33172 USA



**PROLOGIS**

**85,424 Square Feet Industrial Space For Lease**

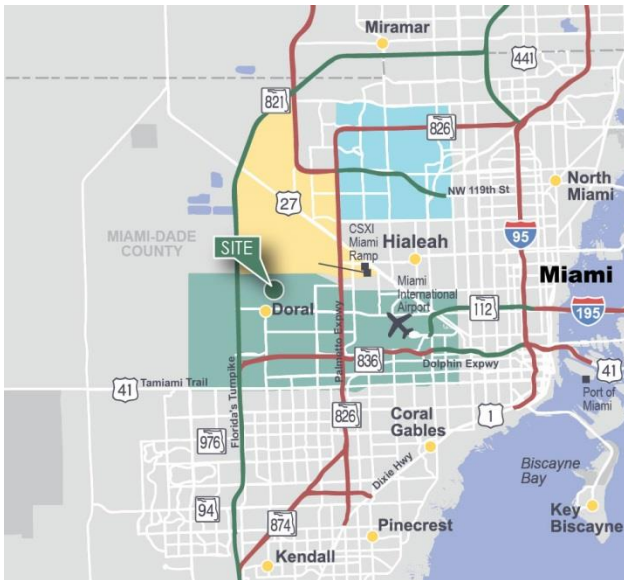

## location

- Easy access to Miami International Airport and Port of Miami
- Direct access to 826 (Palmetto Expressway), 836 (Dolphin Expressway), and Florida's Turnpike

## facility

- 85,424 sf inclusive of 12,155 sf of office
- 100 parking spaces
- 24' Clear Height
- Front Loading
- 10 Dock Doors
- 1 Drive in Ramp
- Available October 2016



**State Street Realty**  
George Pino, SIOR, RPA  
gpino@statestreetre.com  
ph +1 305.447.3390  
cell +1 786.402.7387  
8369 NW 12 Street  
Doral, FL 33126 USA

**State Street Realty**  
Ed Lyden  
elyden@statestreetre.com  
ph +1 305.447.3390  
cell +1 305.562.1001  
8369 NW 12 Street  
Doral, FL 33126 USA

**Prologis**  
Barbara Mantecon-Rodriguez  
bmantecon@prologis.com  
ph +1 305.477.8700  
cell +1 305.793.9369  
8355 NW 12 Street  
Doral, FL 33126 USA

# Prologis Park Beacon Industrial

3200 NW 112 Avenue

Doral, FL 33172 USA



**PROLOGIS**

**85,424 Square Feet Industrial Space For Lease**

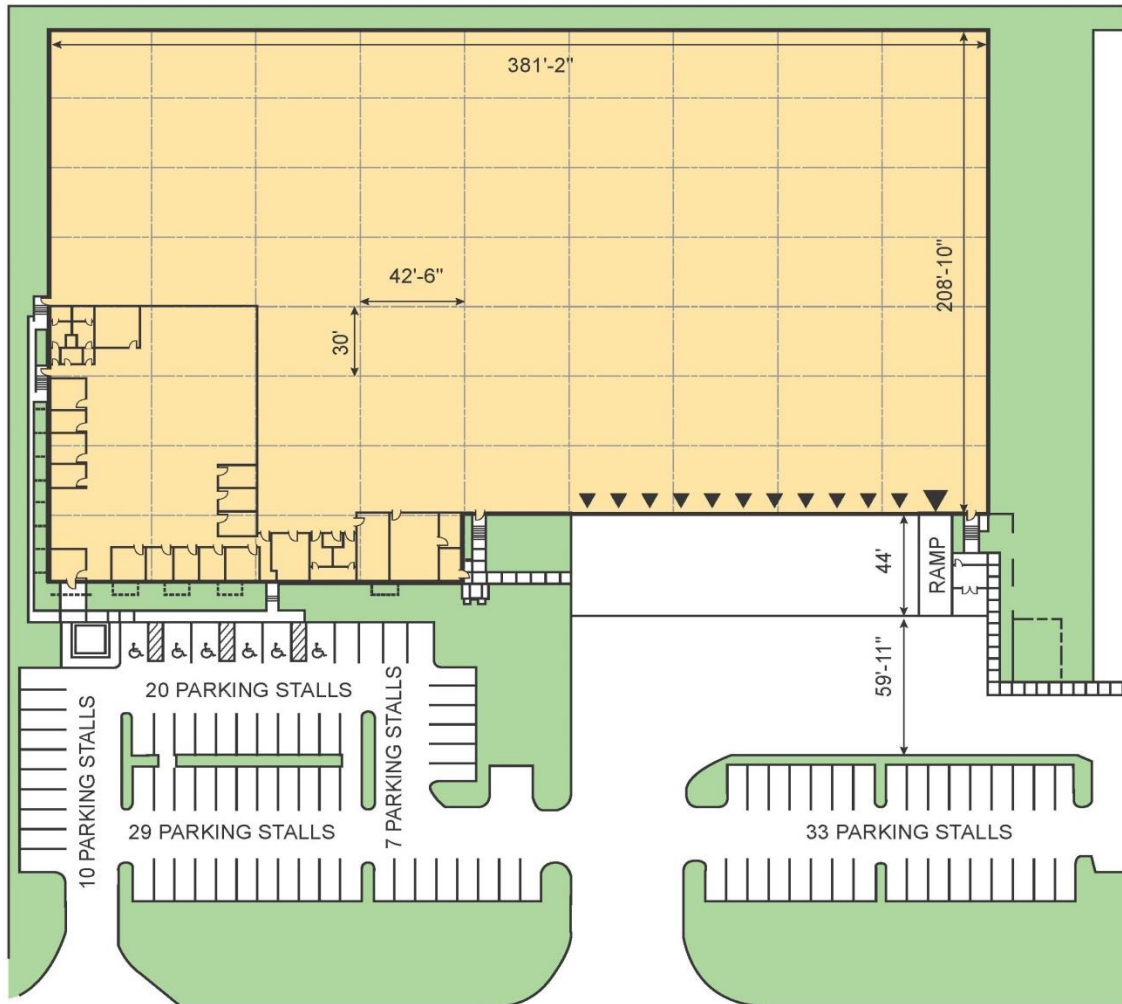

- AVAILABLE AREA
- LEASED AREA
- BACKGROUND LAND

- DOCK DOOR
- DRIVE-IN DOOR



**State Street Realty**  
George Pino, SIOR, RPA  
gpino@statestreetre.com  
ph +1 305.447.3390  
cell +1 786.402.7387  
8369 NW 12 Street  
Doral, FL 33126 USA

**State Street Realty**  
Ed Lyden  
elyden@statestreetre.com  
ph +1 305.447.3390  
cell +1 305.562.1001  
8369 NW 12 Street  
Doral, FL 33126 USA

**Prologis**  
Barbara Mantecon-Rodriguez  
bmantecon@prologis.com  
ph +1 305.477.8700  
cell +1 305.793.9369  
8355 NW 12 Street  
Doral, FL 33126 USA