

# Prologis Miami International Business Park



**PROLOGIS**

**31,727 Square Feet Industrial Space For Lease**

11380 NW 34 Street, Doral, FL 33178 USA



## location

- Easy access to Miami International Airport and Port of Miami
- Direct access to 826 (Palmetto Expressway), 836 (Dolphin Expressway), and Florida's Turnpike

## facility

- NRA +/- 31,727 sf available  
+/- 3,100 sf of office space
- Parking 35 parking spaces
- Clear Height 24'
- Loading Front
- Dock Doors 8 with mechanical pit levelers
- Drive in Ramp 1
- Availability 2<sup>nd</sup> quarter 2012
- Rate \$8.75 PSF / Industrial Gross



**State Street Realty**  
George I. Pino, RPA  
gpino@statestreetre.com  
ph +1 305.447.3390  
cell +1 786.402.7387

Ed Lyden  
elyden@statestreetre.com  
ph +1 305.447.3393  
cell +1 305.562.1001

**Prologis**  
Peter Crovo  
pcrovo@prologis.com  
ph +1 305.477.8700  
fax +1 305.477.8720  
cell +1 786.493.3348  
8355 NW 12 Street  
Doral, FL 33126 USA

# Prologis Miami International Business Park



**31,727 Square Feet Industrial Space For Lease**

**PROLOGIS**

11380 NW 34 Street, Doral, FL 33178 USA

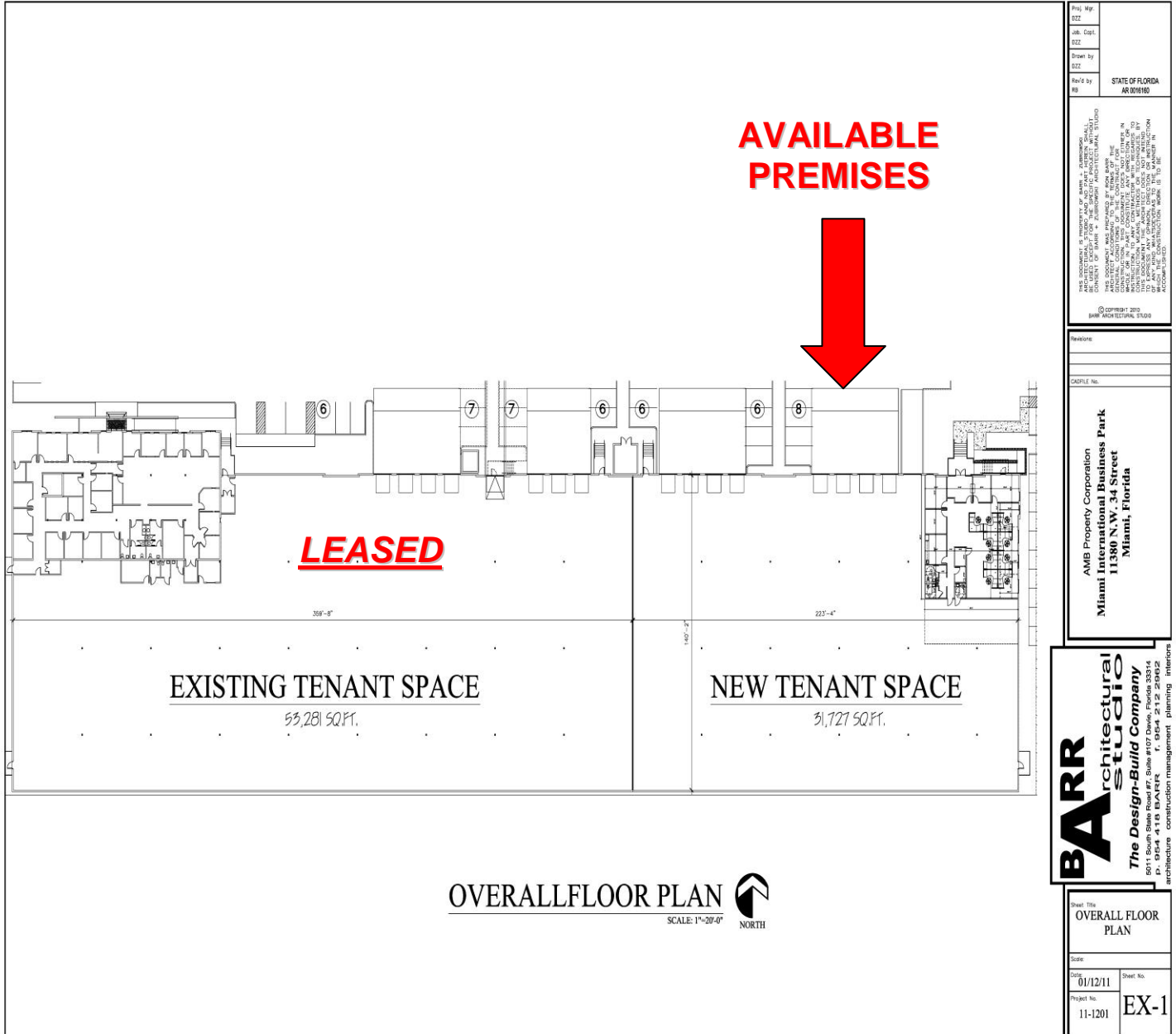

Proj. No.	022
Job. Cpt.	022
Drawn by	022
Rev'd by	STATE OF FLORIDA
RS	AR 000160

THIS DOCUMENT IS THE PROPERTY OF BARR ARCHITECTURAL STUDIO. IT IS TO BE USED ONLY FOR THE PROJECT AND SITE SPECIFICALLY IDENTIFIED HEREON. ANY REUSE OR REPRODUCTION OF THIS DOCUMENT WITHOUT THE WRITTEN PERMISSION OF BARR ARCHITECTURAL STUDIO IS STRICTLY PROHIBITED. THE USER OF THIS DOCUMENT ASSUMES ALL LIABILITY FOR ANY AND ALL DAMAGES, LOSSES OR INJURIES THAT MAY BE INCURRED BY ANY PARTY USING THIS DOCUMENT. THE USER OF THIS DOCUMENT AGREES TO HOLD BARR ARCHITECTURAL STUDIO HARMLESS FROM AND AGAINST ALL SUCH DAMAGES, LOSSES OR INJURIES. THIS AGREEMENT SHALL BE GOVERNED BY THE LAWS OF THE STATE OF FLORIDA.

© COPYRIGHT 2010  
BARR ARCHITECTURAL STUDIO

Revisors	
SCALE No.	
AMB Property Corporation Miami International Business Park 11380 N.W. 34 Street Miami, Florida	

**BARR** architectural studio  
The Design-Build Company  
5011 South State Road #7, Suite #107 Doral, Florida 33114  
P. 954 418 8488 F. 954 251 2342  
architecture construction management planning interiors

Sheet Title	OVERALL FLOOR PLAN
Scale	
Date	01/12/11
Project No.	11-1201
Sheet No.	EX-1



**State Street Realty**  
George I. Pino, RPA  
gpino@statestreetre.com  
ph +1 305.447.3390  
cell +1 786.402.7387

Ed Lyden  
elyden@statestreetre.com  
ph +1 305.447.3393  
cell +1 305.562.1001

**Prologis**  
Peter Crovo  
pcrovo@prologis.com  
ph +1 305.477.8700  
fax +1 305.477.8720  
cell +1 786.493.3348  
8355 NW 12 Street  
Doral, FL 33126 USA

No warranty or representation, expressed or implied, is made as to the accuracy of the information contained herein, and same is submitted subject to error and omissions.